

Volvo 830 - Bug Deflector VV120107

INSTALLATION INSTRUCTIONS

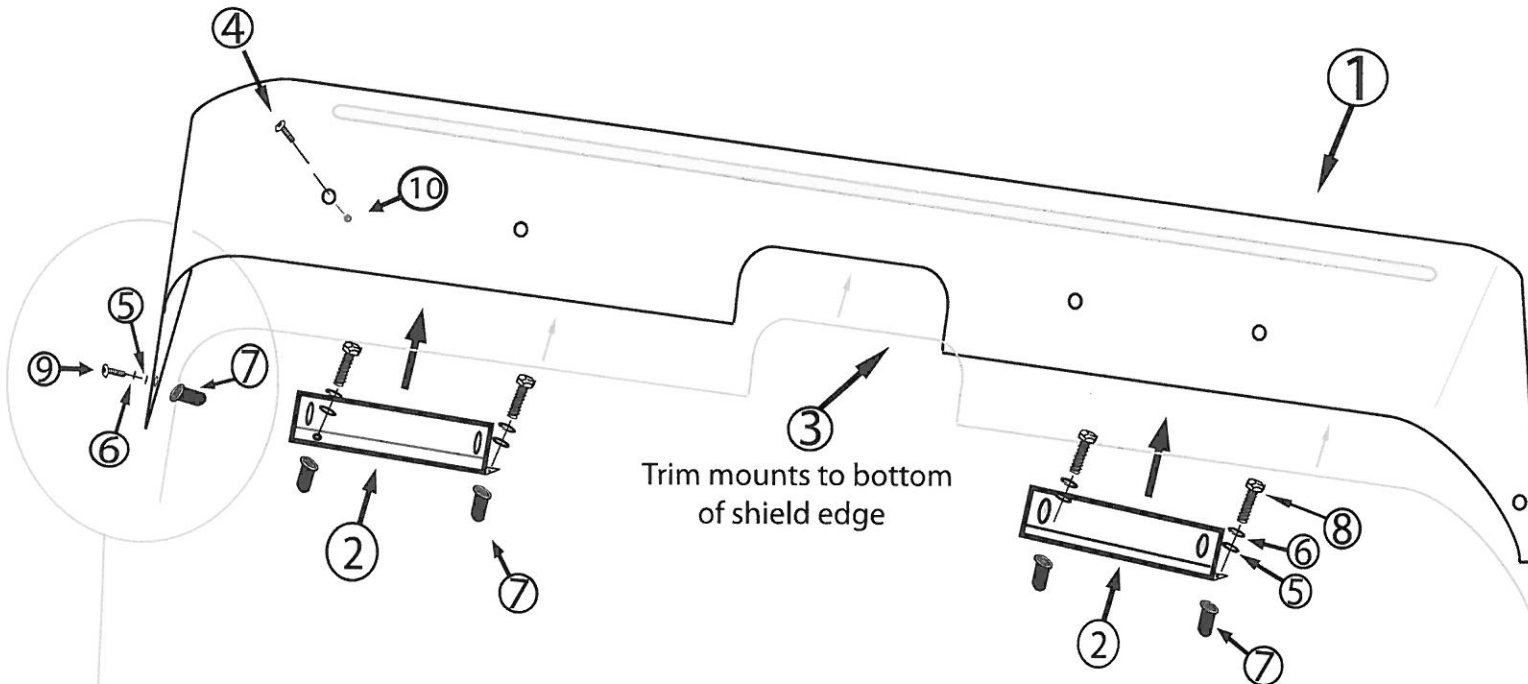

Expanded End Mount View

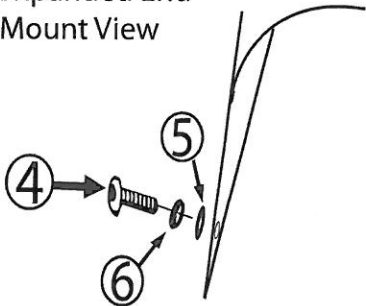

Bracket Application View

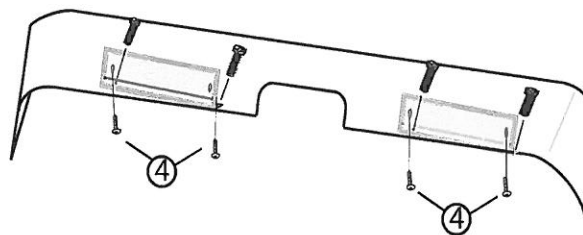

Pkg by

Date

REVISION 2/11

Item	QTY	Description	Size
①	1	Bug Deflector	55" x 12" approx
②	2	Brackets (V120107-1)	10" x 1-1/2"
③	1	Edge Trim	68"
④	4	Truss Head Bolts	10/32 x 1/2"
⑤	6	Flat Washers	1/4"
⑥	6	Lock Washers	1/4"
⑦	6	Rivnuts	1/4"
⑧	4	Hex Bolts	1/4" x 3/4"
⑨	2	Truss Head Bolts	1/4" x 20 x 3/4"
⑩	4	Nylock Nuts	10/32"
⑪	1	Rivnut Tool	

<p>Bug Deflector – Rivnut Mount Installation Instructions</p>

Hood Mount Instructions

(Drilling required)

1. Mount brackets to bug deflector prior to any installation. Place the bug deflector over the 2 brackets and fasten each screw to the bracket with a #10-32 hex Nylock nut on the back side. (Finger tighten only @ this step)
2. Hold bug deflector (w/brackets attached) in desired mounting location and mark holes to drill. (2 for each bracket- total of 4 / **Deflector tips vary by model** – see bug deflector tips for numbers of holes required for mounting. (**Varies from 1 to 2 holes per tip**)).
3. Drill holes (2 each side for brackets and 2 to 4 for tips) in locations marked for desired position. Use 7/16” drill bit to drill holes.
4. Mount rivnuts into truck hood (in holes drilled step 3).
(To mount rivnuts into hood, partially screw in ¼” x 1” hex head bolt into rivnut and insert into hole and tap in with rubber mallet to make sure rivnut is properly seated into hood.). After rivnut is seated, unscrew head to use in bracket mounting.
5. Attach the edge trim to the bug deflector.
6. Attach the 2 brackets to the truck by feeding a ¼” x ¾” hex bolt through each of the 4 holes and fastening them into rivnuts mounted in hood (step 4). Tighten all bolts.
7. Attach the tips of the bug deflector to the side of the truck’s hood by feeding a 1/4" 1” screw and a ¼” flat washer through each of the rivnuts mounted in hood (step 4)
Tip holes vary by model.
8. Tighten all bolts and skin plastic from deflector.
9. Wipe clean with Windex.