

# **Peterbilt 370 & 380 Series**

## **Wicked Gangster 2 Piece Visor Instructions**

### **VP136002**

Safety Glasses	7/16" Wrench
Grinder	Phillips Head Screw Driver
Silicone or "Loctite®"	Window Cleaner and Paper Towels
Masking Tape	
½" Drill bit	

#### **Steps**

1. Before removing current visor; review all hardware and visor prior to installation.
2. Put two visor halves together with center bracket installed between both halves (see diagram on reverse). Do not fully tighten as adjustments will be needed.
3. Hold up visor and mark 2<sup>nd</sup> mounting hole at ear location (to drill).
4. Remove visor, drill ½" hole at marked location at ears, and remove 2 bolts on center windshield post that match holes in center bracket. Bolts removed will be used for re-mounting.
5. Press the rivnuts into ½" holes at visor ends (into cab).
6. To install the center bracket, mount visor onto truck without tightening bolts on ear flaps. You might need another person to assist with the mounting of visor mounted on center of window trim.
7. Reinstall bolts in center visor bracket through windshield post.
8. Tighten all bolts and remove that PVC coating from visor.
9. Wipe away finger prints with window cleaner.

# Peterbilt 13" Wicked Gangster Visor

Fits any 370 or 380 Series

## INSTALLATION INSTRUCTIONS

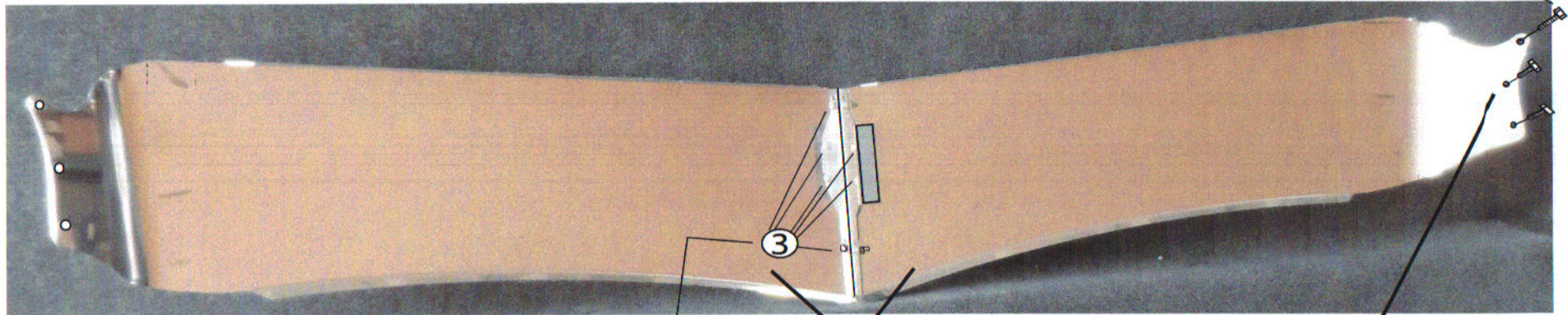

Visor 1/2s Bolt Together



Center Brkt. View

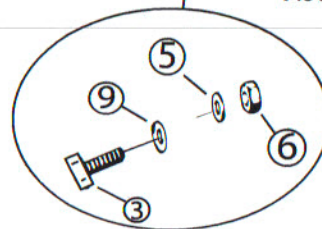

Rivnut Installation Diagram

Tool included in hardware

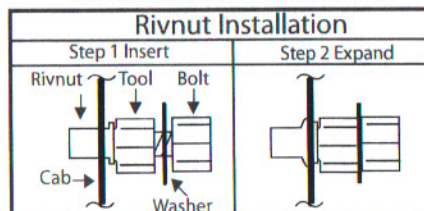

Front View

Packaged By:		Date:	REVISION 9/13
Item	QTY	Description	Size
①	2	Visor body Halve	13.5" x 35"
②	1	Center Visor Brkt	4-3/4" x 1"
③	6	Hex Head Bolts	1/4" x 20 x 3/4"
④	6	Hex Head Bolts	5/16" x 18 x 1"
⑤	12	Washers	1/4" x 20
⑥	6	Nylock Nuts	1/4" x 20
⑦	6	Rivnuts	5/16"
⑧	1	Rivnut Tool	5/16"
⑨	6	Lock Washers	5/16" x 18
⑩	6	Washers	5/16" x 18