

PETERBILT 379 1997-2001 ULTRA

DROPPED VISOR #VP130003-16(13003-16)/VP130000-16

INSTALLATION INSTRUCTIONS

Not D.O.T. Approved

Reuse Original Bolts!

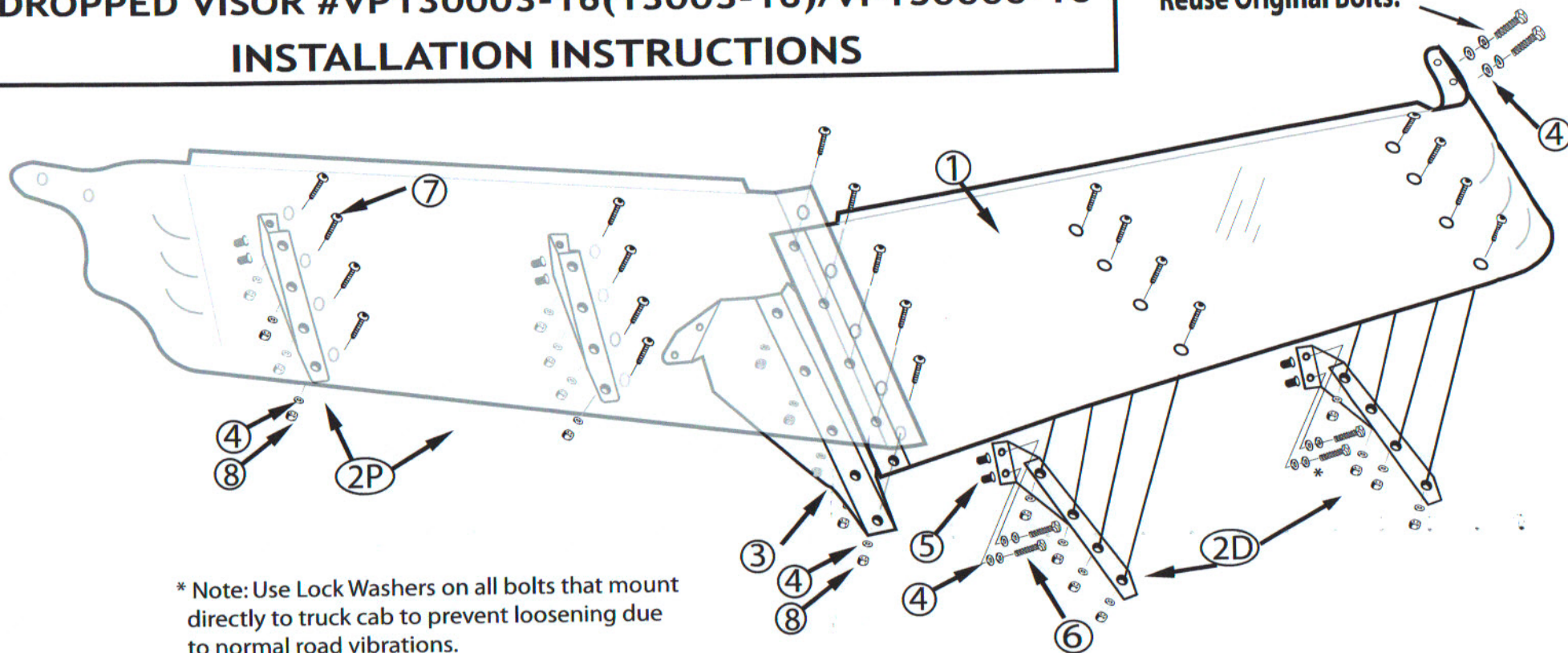

* Note: Use Lock Washers on all bolts that mount directly to truck cab to prevent loosening due to normal road vibrations.

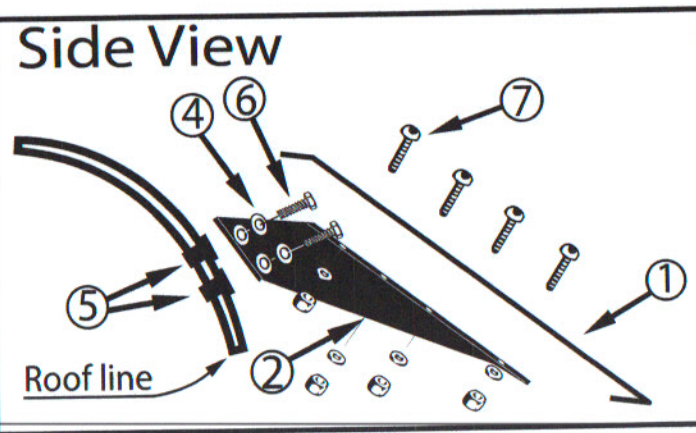
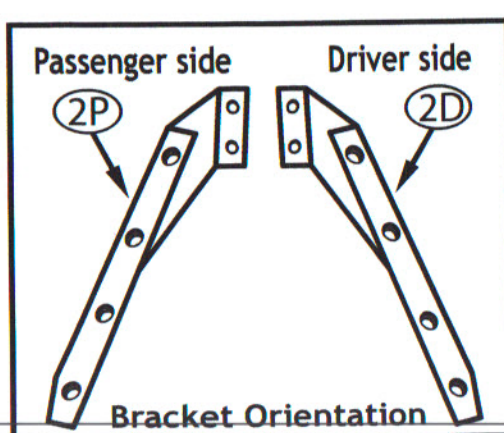

		Pkg by	Date	REVISION 2/11
Item	QTY	Description		Size
①	2	Visor body Halve		13.5" x 35"
②D	2	Outer Visor Brkt (VP130003-16-3) ds		11-3/4" x 1-7/8"
②P	2	Outer Visor Brkt (VP130003-16-4) ps		11-3/4" x 1-7/8"
③	1	Center Visor Brkt (VP130003-2)		1/4-20 x 1/2"
④	34	Washers		1/4
*	16	Lock Washers		1/4
⑤	12	Rubber Welnuts		1/4-20
⑥	12	Hex Head Bolt		1/4-20x1"
⑦	21	Truss Head Machine Screw		13-1/2" x 7" x 3"
⑧	21	Lock Nut		1/4-20

VP 130003-16

379 Peterbilt Drop Visor Instructions

Read Entire Instruction Sheet Before Beginning

Safety Glasses	10mm Metric Wrench
Grinder	7/16" Wrench
Silicone or "Loctite®"	Phillips Head Screw Driver
Masking Tape	Window Cleaner and Paper Towels
½" Drill bit	

Steps:

- 1) Remove your current visor:
 - a) **You will need to reuse the bolts** which go into the side of the cab at the ends of the visor.
- 2) Grind off the heads of the Huck bolts.
 - a) Hold the existing brackets in place and take your time grinding Huck heads. If you grind too fast or hard it will melt the paint around the head. It is recommended that you only grind a little bit at a time.
- 3) Drill out the "Huck" holes with a ½" diameter drill bit.
 - a) Drilling requires you to have a "drill-stop", if you do not have one wrap tape around the drill bit approximately one inch from the tip of the bit, this will prevent "Breaking through" and damaging the interior headliner.
- 4) Press the well nuts into the 1/2" holes. (See Side View illustration)
- 5) Install the mounting bracket per illustration. Once you feel the bolt "bottom out" **STOP TIGHTENING.**
- 6) Install the drivers side portion (Item 1) of the visor first.
 - a) Screw in a couple of turns the "side of cab bolts" through the holes in the end of the visor.
 - b) Start the machine screws into the outside bracket to temporarily hold it in position.
- 7) Repeat Step 6 with the passenger side.
- 8) Where the visors join together, screw in the top and bottom machine screws until finger-tight.
- 9) Align the visor by snugly tightening one of the truss head machine screws in each mounting bracket. Start from the outside of the cab and work toward the middle, one bolt per bracket at a time.
- 10) Remove the PVC coating from the visor.
- 11) Once the visor is in alignment, tighten the machine screws with the Nylock nuts.
- 12) Tighten all remaining bolts and machine screws. We recommend that you use silicone or Loctite® on each of the screws to prevent loosening from over the road use.
- 13) **Use lock washers** on all bolts that fasten directly to cab to prevent loosening.
- 14) Wipe away fingerprints with window cleaner.