

International 9400i Bug Deflector VI120107

INSTALLATION INSTRUCTIONS

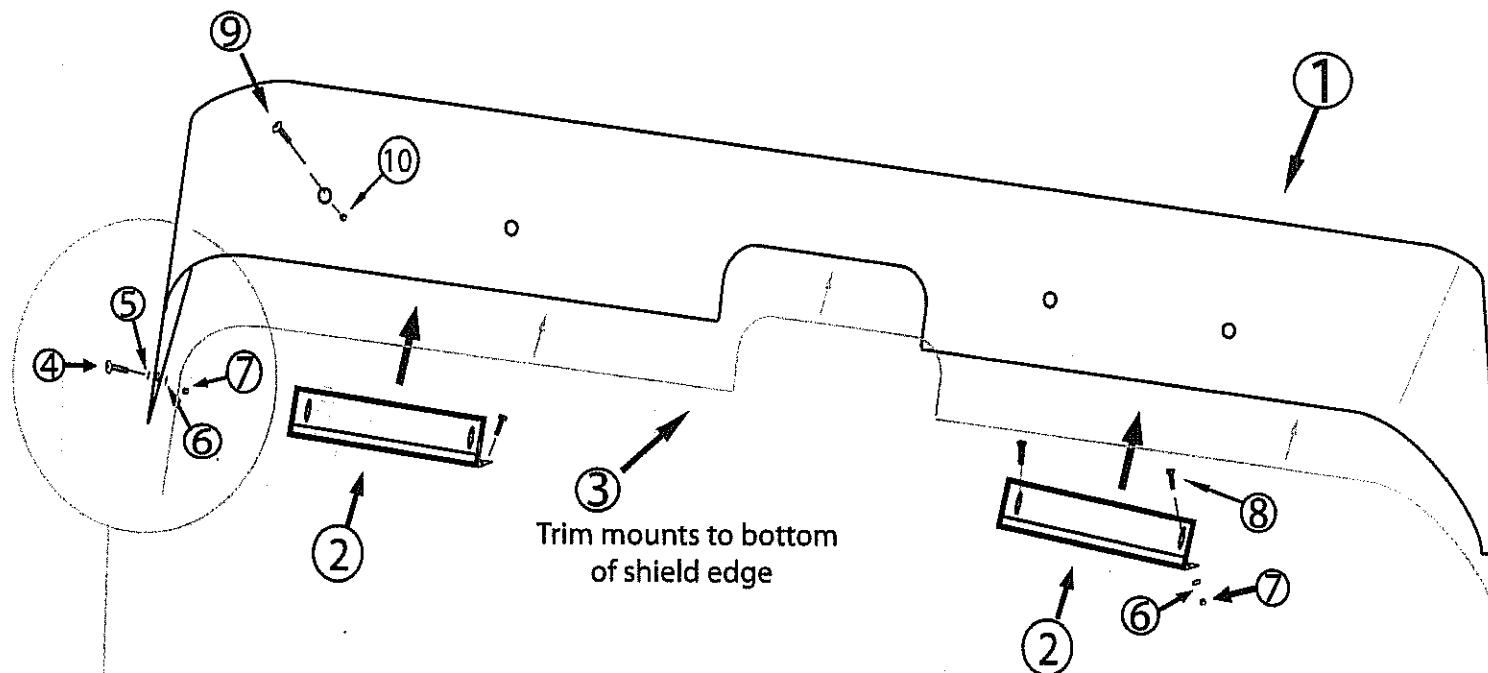

REVISION 1/09

Expanded End
Mount View

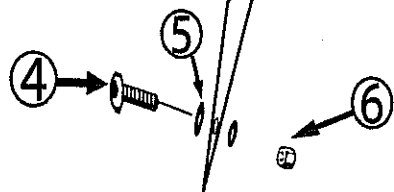

Bracket Application View

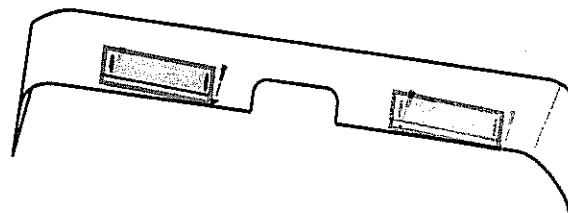

| Item | QTY | Description | Size |
|------|-----|-----------------------|------------------|
| ① | 1 | Bug Deflector | 55" x 12" approx |
| ② | 2 | Brackets (VI120107-1) | 10" x 1-1/2" |
| ③ | 1 | Edge Trim | 68" |
| ④ | 2 | Truss Head Bolts | 1/4" x 3/4" |
| ⑤ | 2 | Flat Washers | 1/4 |
| ⑥ | 6 | Fender Washers | 1/4 x 1.25 o.d. |
| ⑦ | 6 | Nylock Nuts | 1/4-20 |
| ⑧ | 4 | Hex Bolts | 1/4" x 3/4" |
| ⑨ | 4 | Truss Head Bolts | 10/32" x 1/2" |
| ⑩ | 4 | Nylock Nuts | 10/32" |

Bug Deflector
Installation Instructions

Hood Mount Instructions

(Drilling required)

1. Mount brackets to bug deflector prior to any installation. Place the bug deflector over the 2 brackets and fasten each screw to the bracket with a #10-32 hex Nylock nut on the back side.
2. Hold bug deflector (w/brackets attached) in desired mounting location and mark holes to drill. (2 for each bracket- total of 4 / **Deflector tips vary by model** – see bug deflector tips for numbers of holes required for mounting. (Varies from 1 to 2 holes per tip).
3. Drill holes (2 each side for brackets and 2 to 4 for tips) in locations marked for desired position. Use 1/4" drill bit to drill holes.
4. Attach the edge trim to the bug deflector.
5. Attach the 2 brackets to the truck by feeding a 1/4" x 1" hex bolt through each of the 4 holes and fastening them with a 1/4 x 1.25 o.d. fender washer and a 1/4" hex Nylock nut on the backside of the truck assembly. Tighten all bolts.
6. Attach the tips of the bug deflector to the side of the truck's hood by feeding a 1/4" 1" screw and a 1/4" flat washer through each of the 4 holes and fastening them with a 1/4 x 1.25od fender washer and a 1/4" hex Nylock nut on the back side. **Tip holes vary by model.**
7. Tighten all bolts and skin plastic from deflector.

Factory Grille Mount Instructions

(No drilling required-use factory holes)

1. Mount brackets to bug deflector prior to any installation. Place the bug deflector over the 2 brackets and fasten each screw to the bracket with a #10-32 hex Nylock nut on the back side.
2. Hold bug deflector (w/brackets attached) in desired mounting location and mark bolts to remove (2 for each bracket- total of 4 / **Deflector tips vary by model** – see bug deflector tips for numbers of holes required for mounting. (Varies from 1 to 2 holes per tip).
3. Remove selected factory bolts as marked by location (step 2)
4. Attach the edge trim to the bug deflector.
5. Attach the 2 brackets to the truck by feeding factory bolts through each of the 4 holes and fastening them with a 1/4 x 1.25 o.d. fender washer and a 1/4" hex Nylock nut on the backside of the truck assembly (supplied w/deflector). Tighten all bolts.
6. Attach the tips of the bug deflector to the side of the truck's hood using factory bolts through each of the tip holes and fastening them with a 1/4 x .25od fender washer and a 1/4" hex Nylock nut on the back side. **Tip holes vary by model.**
7. Tighten all bolts and skin plastic from deflector.